

**FEMB-LT-ACR**

**Flat Belt, Bottom-Embossed, Top-Smooth,LT - Low Temperature,ACR-Aramid Cord Reinforced**

Material:	Volta MB-LT	
Color (Indicative only)	Blue 15	
Hardness:	95A/46D	
Temp. Range (C°):	-35°C to 50°C	
Temp. Range (F°):	-31°F to 120°F	
Certification:	FDA	

Coefficient of friction (Dry):	
Belt Embossed Bottom -Steel:	0.25

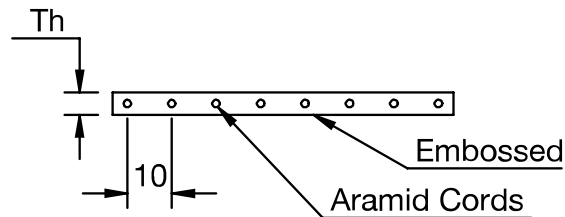

<b>Product:</b>	<b>FEMB-3-ACR-LT</b>	
<b>Belt Thickness (mm)</b>	3	
<b>Belt Weight (kg/ m<sup>2</sup>):</b>	3.6	
<b>Belt Weight (lb/ ft<sup>2</sup>):</b>	0.74	
<b>Belt Min Pulley Diameter (mm)-Normal Flex</b>	48	
<b>Belt Min Pulley Diameter (mm)-Back Flex</b>	48	
<b>Belt Min Pulley Diameter (Inch)-Normal Flex</b>	1.89	
<b>Belt Min Pulley Diameter (Inch)-Back Flex</b>	1.89	
<b>Max. Workload (Kg/cm)</b>	12	
<b>Max. Workload (lb/inch)</b>	67.2	
<b>Pull Force* (kg/cm width) at pretension of:</b>	0.2%	4
	0.3%	6
	0.4%	7.6
<b>Pull Force* (lb/inch width) at pretension of:</b>	0.2%	22.4
	0.3%	33.6
	0.4%	42.5

- Pull Force relates to Steel pulleys. Multiply given values by 0.9 for Cast Iron,1.1 for Rubber and 0.8 for wet smooth drums.
- Pull force in table relates to Finger Splice weld 20x50mm.
- English dimensions have been converted from Metric measurements.
- All values are nominated and to the best of our experience are true and accurate.

The Technical data page is calculated in accordance with a welding area which has the strength of 28 kg/cm. Note that various finger splice methods and different tools can result in differing belt strength.