

**RLB-MD**

**Round Solid Metal Detectable Profile**

Material:	<b>Volta LB-MD</b>	
Color (indicative only)	<b>Blue 09</b>	
Hardness:	80A	
Temp. Range (C°):	-30°C to 55° C	
Temp. Range (F°):	-22° F to 131° F	
Certifications:	FDA / EU	

Coefficient of friction:	
Steel:	0.55
Aluminum:	0.55
Rubber:	0.65

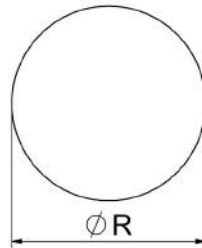

<b>Product:</b>	<b>RLB-5-MD</b>	
<b>Diameter (mm):</b>	5	
<b>Diameter (inch):</b>	3/16	
<b>Belt Weight (kg/ m):</b>	0.025	
<b>Belt Weight (lb/ ft):</b>	0.017	
<b>Belt Min Pulley Diameter (mm)-Normal Flex</b>	40	
<b>Belt Min Pulley Diameter (Inch)-Normal Flex</b>	1 <sup>9</sup> / <sub>16</sub>	
<b>Max. Workload (Kg)</b>	2	
<b>Max. Workload (lb)</b>	3.6	
<b>Pull Force (kg) at pretension of:</b>	1%	0.4
	2%	0.8
	3%	1.2
<b>Pull Force (lb) at pretension of:</b>	1%	0.9
	2%	1.8
	3%	2.7
<b>Splice Type:</b>	Butt welding	

**Notes:**

1. Pull Force in tables relate to grooved steel and aluminum grooved pulleys. Multiply given values by 0.7 for wet pulleys.
2. Dimensions have been converted from metric measurements.
3. All values are nominal and to the best of our experience are true and accurate.