

## RPZ

Round Solid texturized or Smooth Profile

Material:	<b>Volta PZ, Green05</b>
Hardness:	86A / 35D
Temp. Range:	- 20 °C to +50 °C

Coefficient of friction :	
Texturized:	0.4
Smooth:	0.6

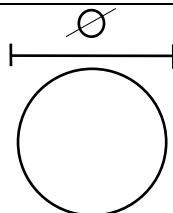

## RPZ

BELT TYPE	DIAMETER Ø mm	WEIGHT kg / m	MIN. PULLEY Ø mm	MAX. WORK LOAD kg	PULL FORCE (kg)(for Texturized) AT PRETENSION		
					1 %	2 %	3 %
RPZ - 3	3	0.009	26	1.6	0.26	0.52	0.78
RPZ - 4	4	0.015	35	3.1	0.51	1.02	1.53
RPZ - 5	5	0.024	45	4.7	0.8	1.6	2.4
RPZ - 6	6	0.034	54	7	1.16	2.32	3.48
RPZ - 7	7	0.05	63	9.5	1.56	3.12	4.68
RPZ - 8	8	0.06	72	12.5	2.05	4.1	6.15
RPZ - 9	9	0.08	80	16	2.64	5.28	7.92
RPZ - 10	10	0.10	89	20	3.2	6.4	9.6
RPZ - 12	12	0.14	108	29	4.65	9.3	13.95
RPZ - 15	15	0.21	135	45	7.25	14.5	21.75
RPZ - 18	18	0.031	160	65	10.2	20.4	30.6
RPZ - 20	20	0.038	180	78	12.5	25.0	37.5

### Notes:

1. Pull Force in tables relate to texturized profile working on grooved steel, aluminum or cast iron pulleys. Multiply by 0.7 for wet pulleys.
2. For smooth profiles Multiply given values by 1.05 .
3. All values are nominal and to the best of our experience are true and accurate.
4. All belt types can be manufactured with smooth surface under special request.  
Check availability before placing the order.

**RPZ**

Round Solid texturized or Smooth Profile

Material:	<b>Volta PZ, Green 05</b>
Hardness:	86A / 35D
Temp. Range:	- 0 °F to +120 °F

Coefficient of friction :	
Texturized:	0.4
Smooth:	0.6

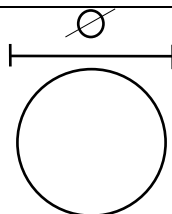

**RPZ**

BELT TYPE	DIAMETER Ø inch	WEIGHT lb / ft	MIN. PULLEY Ø inch	MAX. WORK LOAD lbs	PULLFORCE (lbs) AT PRETENSION		
					1 %	2 %	3 %
RPZ- 3	1/8	0.006	1	3.53	0.57	1.15	1.72
RPZ- 4	5/32	0.010	1 3/8	6.83	1.12	2.25	3.37
RPZ- 5	6/32	0.016	1 3/4	10.36	1.76	3.53	5.29
RPZ - 6	7/32	0.023	2 3/16	15.43	2.56	5.11	7.67
RPZ - 7	9/32	0.03	2 1/2	20.94	3.44	6.88	10.32
RPZ - 8	5/16	0.04	2 7/8	27.56	4.52	9.04	13.56
RPZ - 9	11/32	0.05	3 1/8	35.27	5.82	11.64	17.46
RPZ - 10	7/16	0.06	3 1/2	44.09	7.05	14.11	21.16
RPZ - 12	15/32	0.09	4 1/4	63.93	10.25	20.5	30.75
RPZ - 15	19/32	0.14	5 5/16	99.21	15.98	31.97	47.95
RPZ- 18	23/32	0.21	6 5/16	143.3	22.49	44.97	67.46
RPZ- 20	13/16	0.26	7 1/16	171.96	27.56	55.11	82.67

Notes:

1. Pull Force in tables relate to grooved steel, aluminum and Cast-Iron pulleys. Multiply given values by 0.7 for wet pulleys.
2. Dimensions have been converted from metric measurements.
3. All values are nominal and to the best of our experience are true and accurate.
4. All belt types can be manufactured with smooth surface under special request. Check availability before placing the order.