

VLW-RT

Trapezoidal Ridge-Top Reinforced Profile

Material:	Volta LW	
Color (indicative only)	White 16	
Hardness:	80A	
Temp. Range (F°):	-40° F to + 130° F	
Certification:	FDA /EU	

Coefficient of friction:	
Steel:	0.55
Aluminum:	0.55
Rubber:	0.65

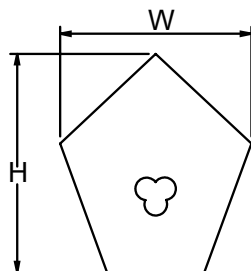

Product	Dimensions W x H Inch X Inch	Weight lb/ft	Minimum Pulley Ø Inch		Pull Force (lb.) at 1% Pretension	Maximum % Pretension		Drill Bit
			Butt Weld	EZOL Join		Butt	EZOL	
VLW-A-RT	1/2 x 11/32	0.1	4 ⁵ / ₁₆	5 ³ / ₁₆	72	0.50%	3.5%	I
VLW-B-RT	5/8 x 49/64	0.17	5 ¼	6 ¼	84	0.75%	3.5%	II
VLW-C-RT	7/8 x 31/32	0.30	6 ½	7 ¾	168	0.75%	3.5%	III

Notes:

1. Pull Force in tables relate to Steel and Aluminum grooved pulleys.
Multiply given values by 0.7 for wet pulleys.
2. Dimensions have been converted from metric measurements.
3. All values are nominal and to the best of our experience are true and accurate.